

Rena Flow 350/1500 450/2000 Instructions and Warranty

Failure to follow the instructions and warnings in this manual may result in pump damage

Rena Flow water pumps are oil-free, magnetic-drive water pumps. Never operate without having water in the pump. This is particularly, important when used in a small fountain with very little water.

DO NOT RUN THIS PUMP DRY!

The pumps are completely submersible in the pond or can be used externally as an in-line, flooded-suction pump. The motor has no seals to wear out and does not need to be oiled.

This Rena Flow water pump can be operated outdoors or indoors and is Underwriters Laboratory approved.

Rena pumps are meticulously inspected and tested to ensure both safety and operating performance.

SAFETY CAUTIONS-Read and follow all safety instructions. Disconnect the power supply to all electrical equipment in the pond or fountain basin before putting your hands in the water! While the pump is plugged into a power supply, do not handle pump with wet hands, on a wet surface or immersed in water. Do not expose pump to temperatures below freezing.

Electrical Connections: Always use a properly grounded receptacle. Do Not immerse plug in water. A ground fault circuit Interrupter (GFCI) is required. See your local electrical supply dealer or contact an electrician for various brands of GFCI. Do not operate if power cord is damaged in any way. Pump must be unplugged when handling.

Pre-filter: The strainer and foam pre-filter are designed to protect the pump by preventing foreign materials from entering the pump and causing damage. A pre-filter prevents fish and other pond inhabitants from coming in contact with the impeller. If you have to clean the pre-filter sponge on a daily basis, you may want to consider using a separate pond filter. If the pump is used in a fountain without fish or plants it may work fine without any pre-filter. Follow the fountain manufacturers recommendations.

Flow Control/ Pump Impeller Cover: The flow control is a simple valve that blocks the outflow of water. Turn the valve in either direction to adjust the flow. To remove the impeller cover, carefully twist the cover counter-clockwise and pull the cover straight out. The cover comes equipped with an O-ring to insure a proper seal. Always inspect the O-ring for damage prior to replacing the impeller cover (see illustration 2). This pump is equipped with a ceramic shaft. Please use caution when reinstalling the rotor and replacing the impeller cover as this shaft will break if not properly handled.

Service your pump: The pump impeller cover must be removed to clean and inspect the impeller. Periodic cleaning of your pump will maintain your pumps performance. This pump is equipped with a ceramic shaft. Please use caution when reinstalling the rotor and replacing the impeller cover as this shaft will break if not properly handled. It is recommended that you check your pump every month or when flow is reduced. If the Impeller is chipped or broken it should be replaced. This will restore the pump to its original pumping capacity. The impeller is lubricated by water, so it is essential to never run the pump without water (see Illustration 2).

Note: In you experience extremely hard water (white scale forms on the surfaces), algae (green or slimy film forms) or foaming conditions there are several remedies available. For mineral deposits use vinegar. Soak the affected parts in vinegar and gently brush away the white scale, using a small brush similar to a bottle brush.

Aquarium Pharmaceuticals, Inc. makes a line of products to solve all three problems. White Scale Control, Algae Destroyer and Anti-Foam are available at retail outlets nationwide or by calling our parts distributor Rena OEM

Sales at 800-968-7362. Visit them on the web at www.RenaPump.com to purchase parts or get answers to all your Rena questions.

5 YEAR RENA LIMITED WARRANTY

RENA warrants this product against defects in material and workmanship to the original retail consumer for a period of five (5) years after the date of purchase. The manufacturer's responsibility and liability is limited to replacing any such defective product. This warranty does not cover or apply to improper use or installation, normal wear of parts available as spare parts, failure to follow or comply with the enclosed instructions or if the product has been tampered with or altered.

To obtain performance under this warranty, you must follow these instructions:

1) Do not return this product to the place of purchase: doing so may delay the processing of your claim. 2) Call Technical Services **1-800-847-0659** to obtain a return authorization number. At this time, our technical service representative may be able to assist you in correcting the problem. 3) Pack the pump carefully. A) Enclose a brief description of the defect with your name and mailing address. B) Enclose a copy of your warranty registration and your purchase receipt. C) Enclose \$5.00 for postage and handling. D) Send your pump to: Aquarium Pharmaceuticals, Inc., Attention: Warranty, 50 East Hamilton Street, Chalfont, PA 18914 E) Mark the box with the return authorization number given to you on the phone. F) Allow 30 days for the return of your pump. No representative has any authority to change or enlarge the above warranty or our liability. This warranty gives you specific legal rights and you also may have other rights, which vary from state to state. **WE EXCLUDE AND ARE NOT RESPONSIBLE FOR ANY CONSEQUENTIAL DAMAGES (SUCH AS DAMAGE TO OR LOSS OF FISH, ANIMATE MATTER OR PERSONAL PROPERTY) NOR FOR ANY IMPLIED WARRANTY, WHICH RELATES TO OUR PRODUCT.** Some states do not allow the exclusion of limitation of incidental or consequential damages, so the above limitation or exclusion may not apply to you. **RENA FRANCE, Annecy, France**
AQUARIUM PHARMACEUTICALS, INC., P.O. Box 218 – Chalfont, PA 18914

**PIECES DETACHEES
SPARE PARTS**

**Rena Flow 350-1500 SA-Pd
Rena Flow 450-2000 SA-Pd**

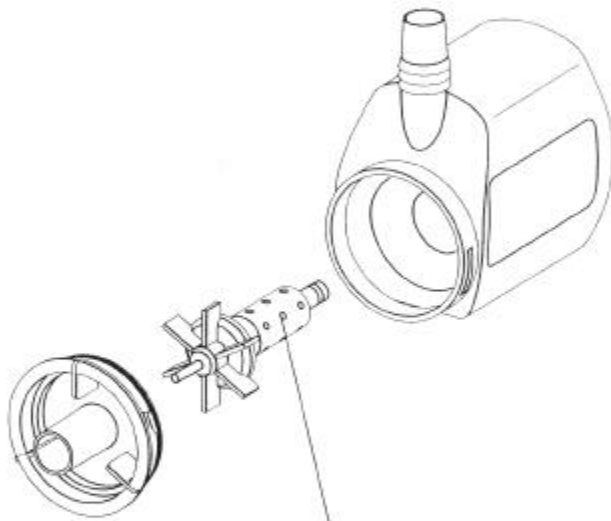

Rena Flow 350-1500 SA-Pd
ADE 042-00

Rena Flow 450-2000 SA-Pd
ADE 043-00

**Parts List for Rena Flow 350-RF1500
Rena Flow 450-RF2000**

1. RTR1500 Rotor/Shaft/Bearing for
Rena Flow 350-RF1500
2. RTR2000 Rotor/Shaft/Bearing for
Rena Flow 450-RF2000

INSTALLATION

ON

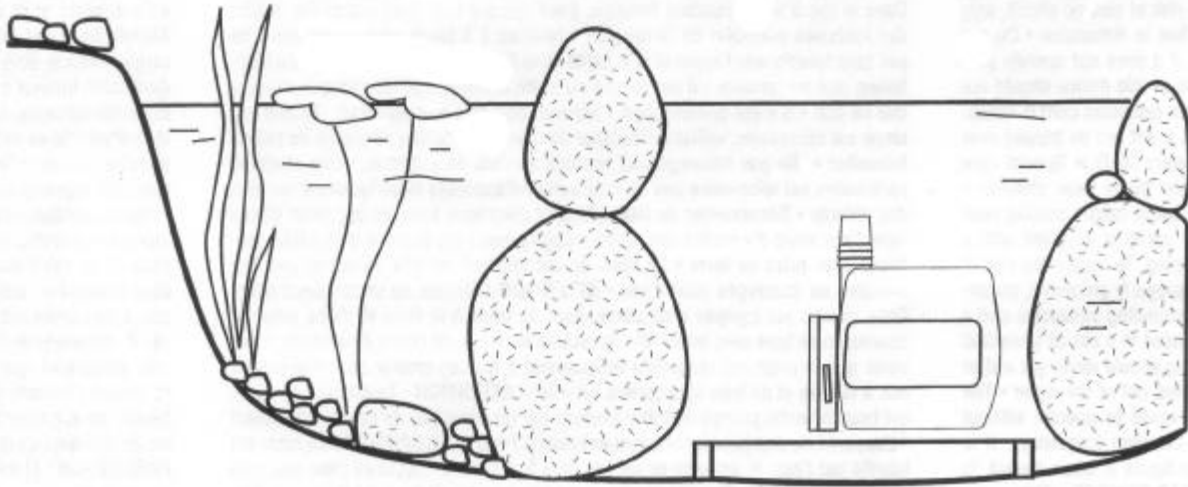

1

**ENTRETIEN
MAINTENANCE**

OFF

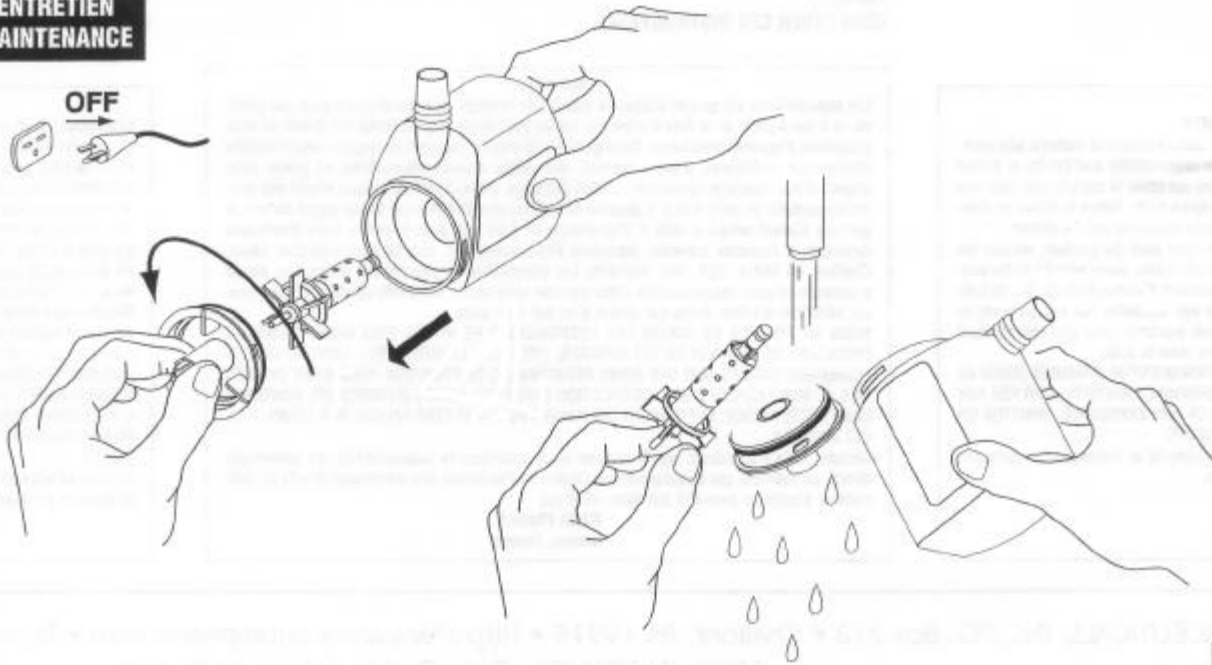

2